

Jackson-Pratt (JP) Drain Care

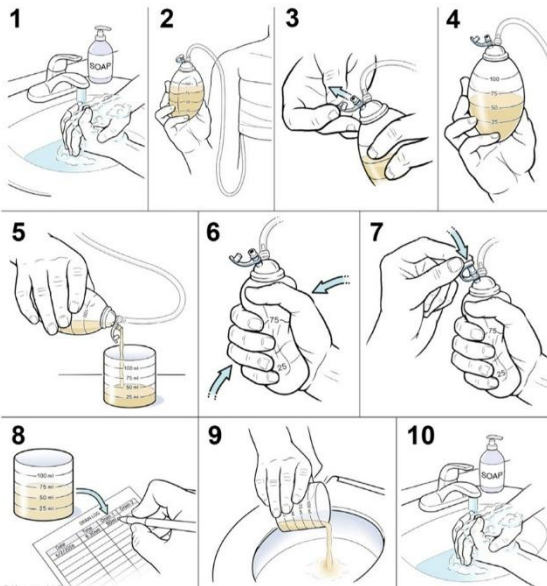
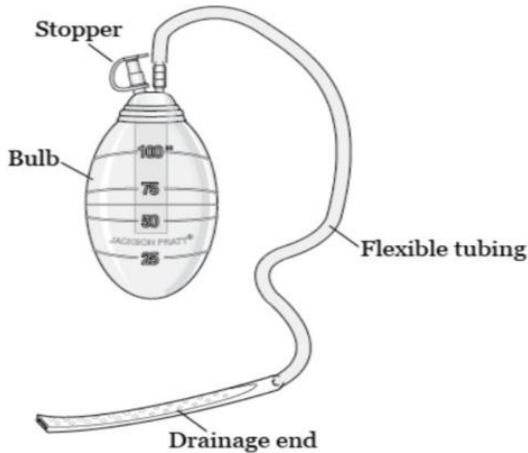

EMPTYING THE DRAIN(S)

1. Wash your hands with soap and water.
2. Hold the bulb upright (plug/cap on top).
3. Remove the drainage plug/cap.
4. This will release pressure.
5. Turn the bulb upside down and GENTLY squeeze the fluid in the medicine cup for accurate measurements in ml or cc's they are the same.
6. Squeeze the blub in the center.
7. While squeezing close the drainage plug. The bulb will stay collapsed or concave.
8. Record your output for each drain **Separately** on the form provided.
9. Empty contents in the toilet.
10. Wash hands.

Proper JP drain care is essential to your physical recovery. Please contact our office if your concerns are not addressed by the following instructions.

Depending on the type of surgery, your surgeon may send you home with one or more bulb shaped drains. Drains remove fluid from the surgical site and assists with wound healing. The most common drain is the Jackson Pratt drain, which has a small “hand grenade” shaped bulb at the end of a plastic tube. The drain is secured to the body with a stitch to minimize accidental removal. When the bulb is squeezed, a vacuum is created. This gentle suction helps draw out any fluid collections.

HOW TO CARE FOR YOUR DRAIN

JP drain output needs to be properly measured and recorded for your surgeon to determine when it can be safely removed.

The collection bulb should always be collapsed or concave to maintain continuous suction. The bulb should be collapsed by squeezing the center of the bulb. The bulb needs to be emptied when it is filled with fluid, or the bulb is no longer on suction.

Before emptying the drain it should be “stripped”. Use one hand to hold the drain **securely** next to the insertion site and using the other hand's thumb and forefinger squeeze all the way down the tube toward to the bulb. Be careful to stabilize the drain and not to pull the tube out. Using an alcohol wipe will help your hand slide easier. Pinch the tube when your hand stops sliding, then release the other hand to create a vacuum that should dislodge any clots or clog material.

IMPORTANT

The bulb may be pinned to clothing with a safety pin to prevent it from being dislodged or pulled. (Don't forget to unpin it when undressing). When you shower, you can secure your drains to a lanyard necklace or drain pouch for ease and to keep the drains from dangling.

Drain issues are rarely emergencies, even if they fall out. Please read Troubleshooting prior to calling the office.

TROUBLESHOOTING (PLEASE READ PRIOR TO CALLING OFFICE)

Problem	What to do?
Drain is not holding suction	Make sure the cap is securely in place completely compressed.
Drain is pulled or falls out	Do NOT attempt to replace. Place a Band-Aid over the skin opening and notify the office during business hours.
Drain site is leaking fluid	Sometimes the drain is clogged or insufficient to remove the fluid building up. Reinforce the dressing around the drain and change when saturated. If frequent dressing changes are noted, notify the office during business hours.
Drain output is slows or stops	Attempt to strip the drain to ensure it isn't clogged. If nothing comes out, there may be nothing to drain. If the surgical site is enlarged or painful, notify the office.
Drain and bulb have "clots" or solid material	You may notice some thick or solid clots or whiteish material in the drain tubing or bulb especially after a few days or weeks. This is normal. Continue to drain output. Continue to strip drain as described on sheet 1 "Caring for your drain".
Drain site is red and/or painful	Some localized redness and discomfort are to be expected at the immediate drain site. If redness is larger than the size of a quarter, and swelling/heat or pus present, call the office. Before calling, please take your temperature and let us know if your temperature is 101F (38.3C) or higher.

You will be shown how to care for your drain at your pre-operative appointment by our Nurse or Medical Assistant. You may also ask for a second demonstration before your discharge. You can always ask for help even after you have begun to care for it yourself. If you have any problems after discharge, please read instructions and then call our office if needed. 248-799-2880

This Youtube video demonstrates much of what is contained in this handout and is very helpful educational guide.

JACKSON-PRATT
DRAIN CARE
 CHAU PLASTIC SURGERY

